

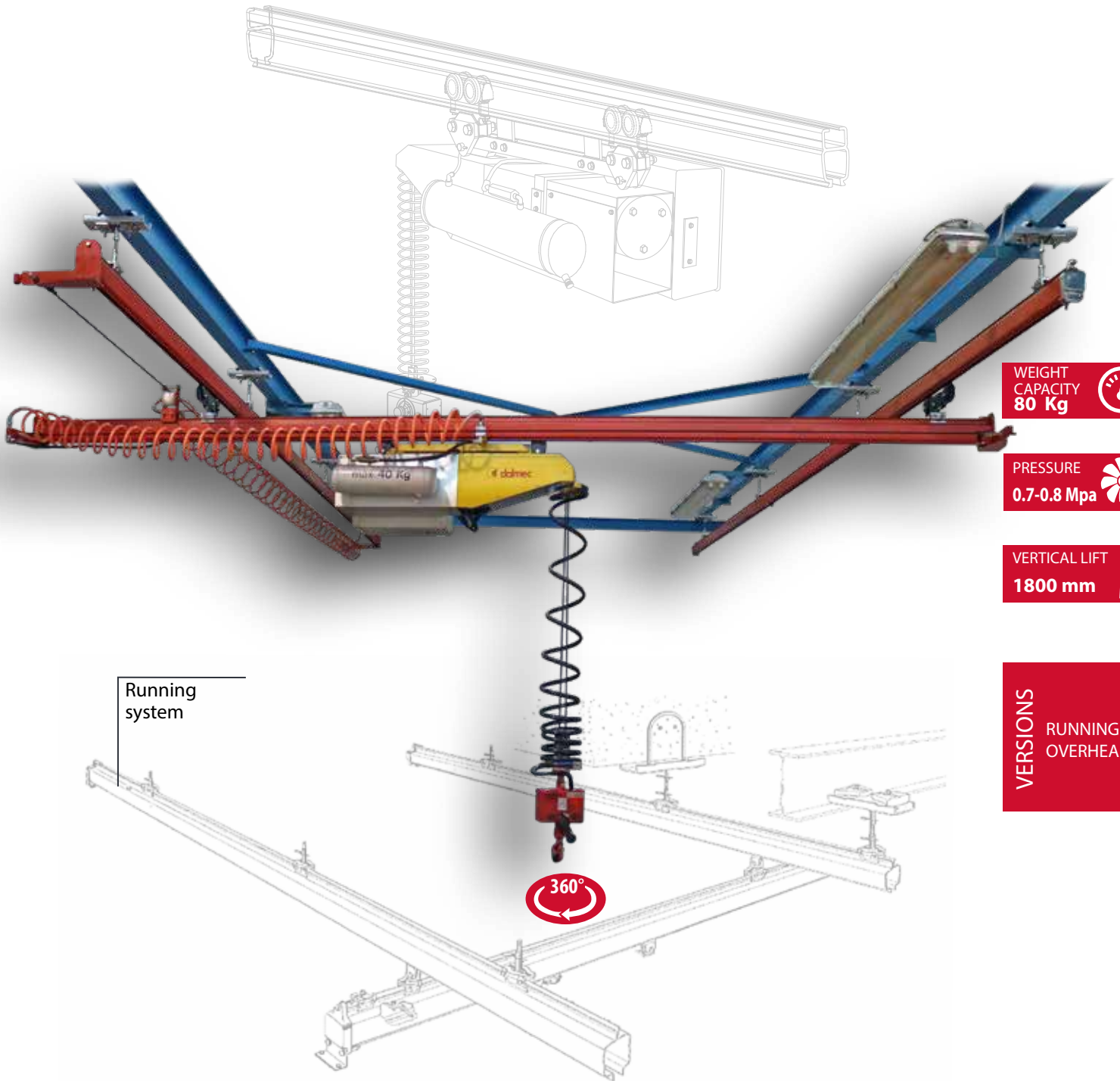

## Industrial Manipulators



Pneumatic Manipulator **MINIPARTNER MP** with double cable

MINIPARTNER MP equipped with special gripping tools, allows the handling of loads in a weightless condition in any direction. The gripping tool is connected to the balancing group by two single cables to guarantee max safety. Mounted on a bridge crane with double runways, it offers an easy translation in order to cover a large working area.

# MINIPARTNER<sup>®</sup> - MP

## Minipartner overhead trolley mounted - MPS

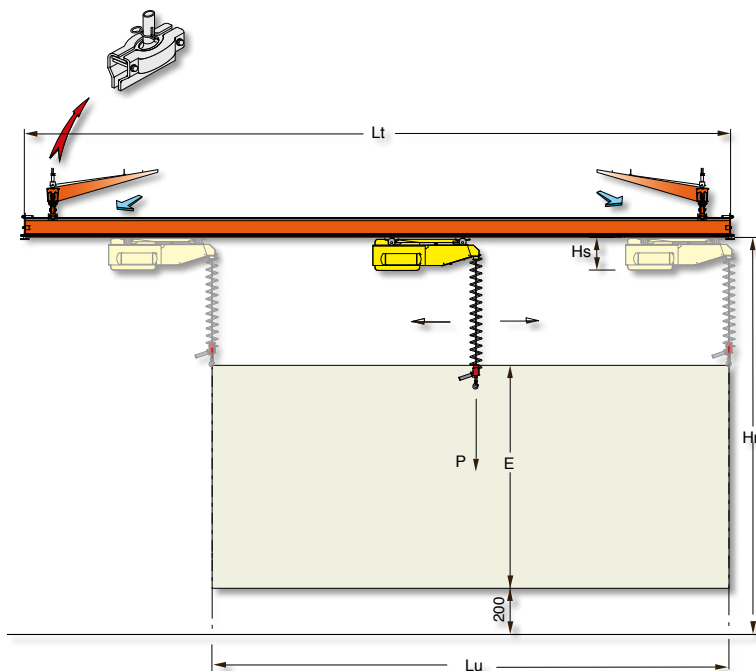

**MINIPARTNER overhead trolley mounted "MPS"**

Max weight capacity	P	80	Kg
Bridge length	Lt	4000÷7000	mm
Working length	Lu	3100÷6100	mm
Vertical lift	E	1800	mm
Overall dimension	Hs	320	mm
Height under bridge	Hr	3100	mm
Air supply	Dry and oil-free compressed air min constant 0.7÷0.8 MPa		

Configuration and measurements may change upon the Customer's specific requirements

## Minipartner Plus overhead trolley mounted - MPS

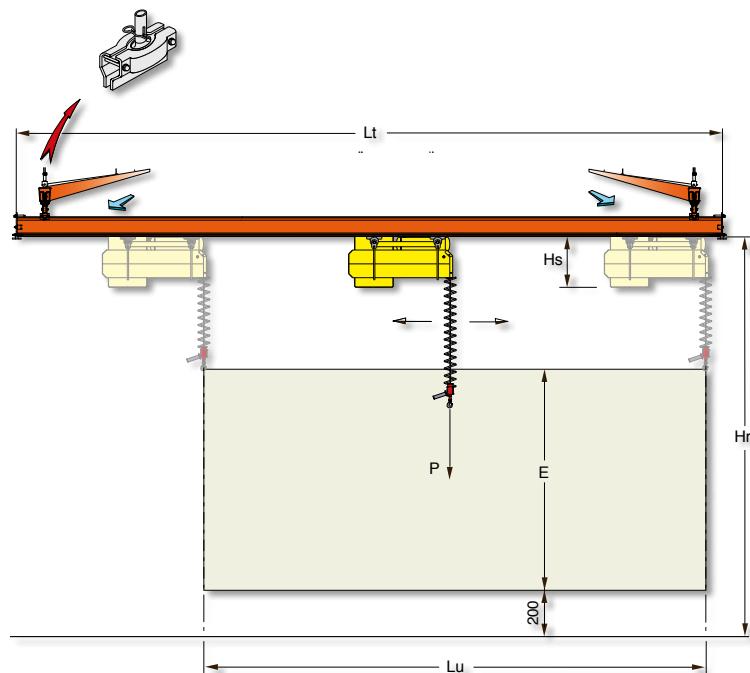

**MINIPARTNER PLUS**

MODEL	PLUS 8	PLUS 6	
Max weight capacity	P	170	220 Kg
Bridge length	Lt	4000÷7000	4000÷7000 mm
Working length	Lu	3250÷6250	3250÷6250 mm
Vertical lift	E	2000	1500 mm
Overall dimension	Hs	435	435 mm
Height under bridge	Hr	3150	2650 mm
Air supply	Dry and oil-free compressed air constant 0.7÷0.8 MPa		

Configuration and measurements may change upon the Customer's specific requirements